

Wiring Diagrams | Rotary Mechanisms

DO, DO LOW, GARBY, GARBY COLONIAL and VENEZIA Collections

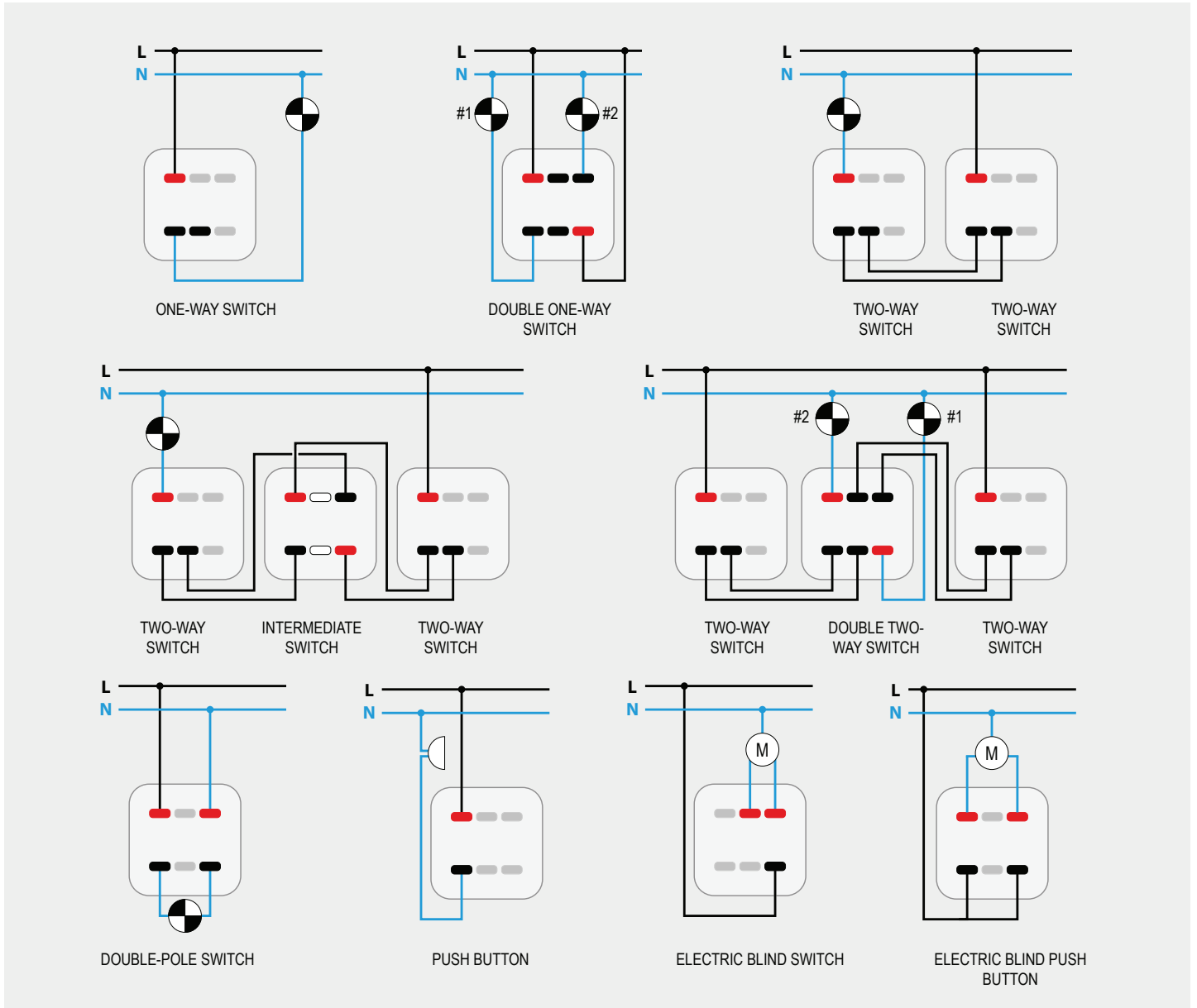

OPERATION DIAGRAMS:

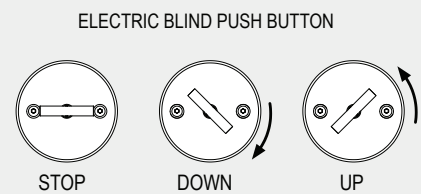
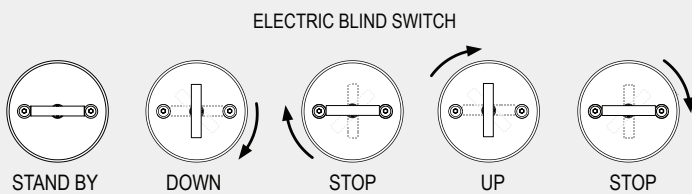
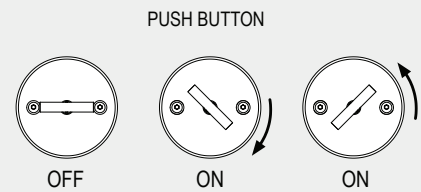
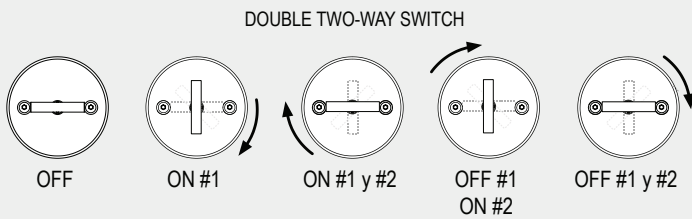

Wiring Diagrams | Toggle Mechanisms

DIMBLER, VENEZIA and 1950 Collections

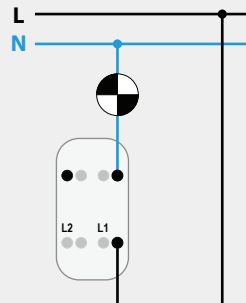

ONE-WAY SWITCH

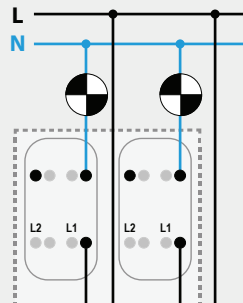

DOUBLE ONE-WAY SWITCH

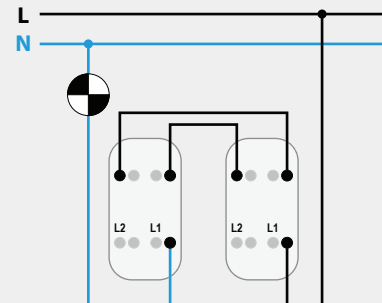

TWO-WAY SWITCH TWO-WAY SWITCH

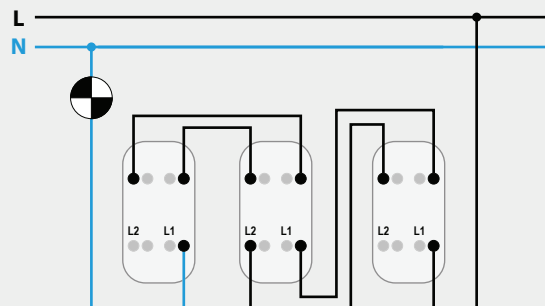

TWO-WAY SWITCH INTERMEDIATE SWITCH TWO-WAY SWITCH

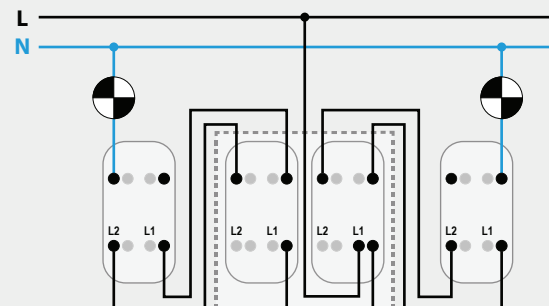

TWO-WAY SWITCH DOUBLE TWO-WAY SWITCH TWO-WAY SWITCH

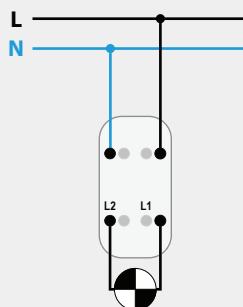

DOUBLE-POLE SWITCH

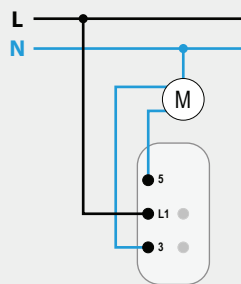

ELECTRIC BLIND SWITCH

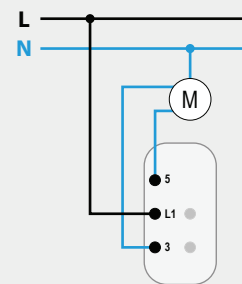

ELECTRIC BLIND PUSH BUTTON

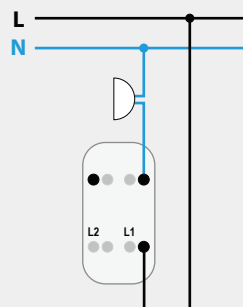

PUSH BUTTON

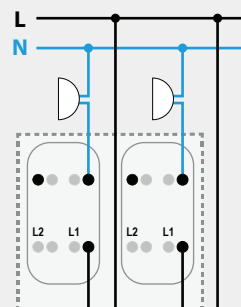

DOUBLE PUSH BUTTON

Wiring Diagrams | Dimmer Switches

DO, DO LOW, GARBY, GARBY COLONIAL, DIMBLER, VENEZIA AND 1950 Collections

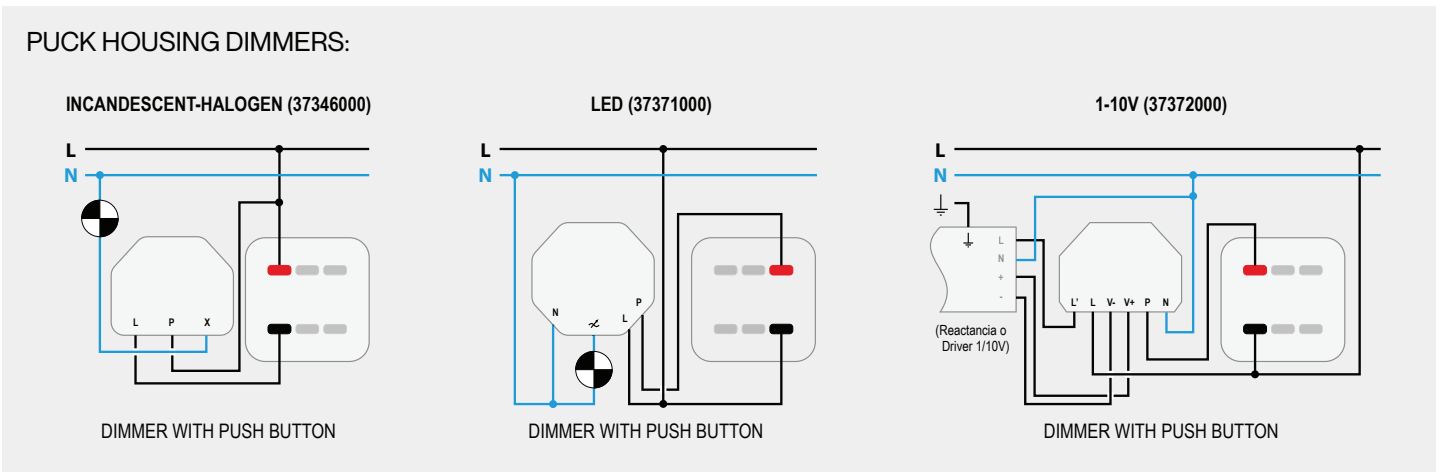
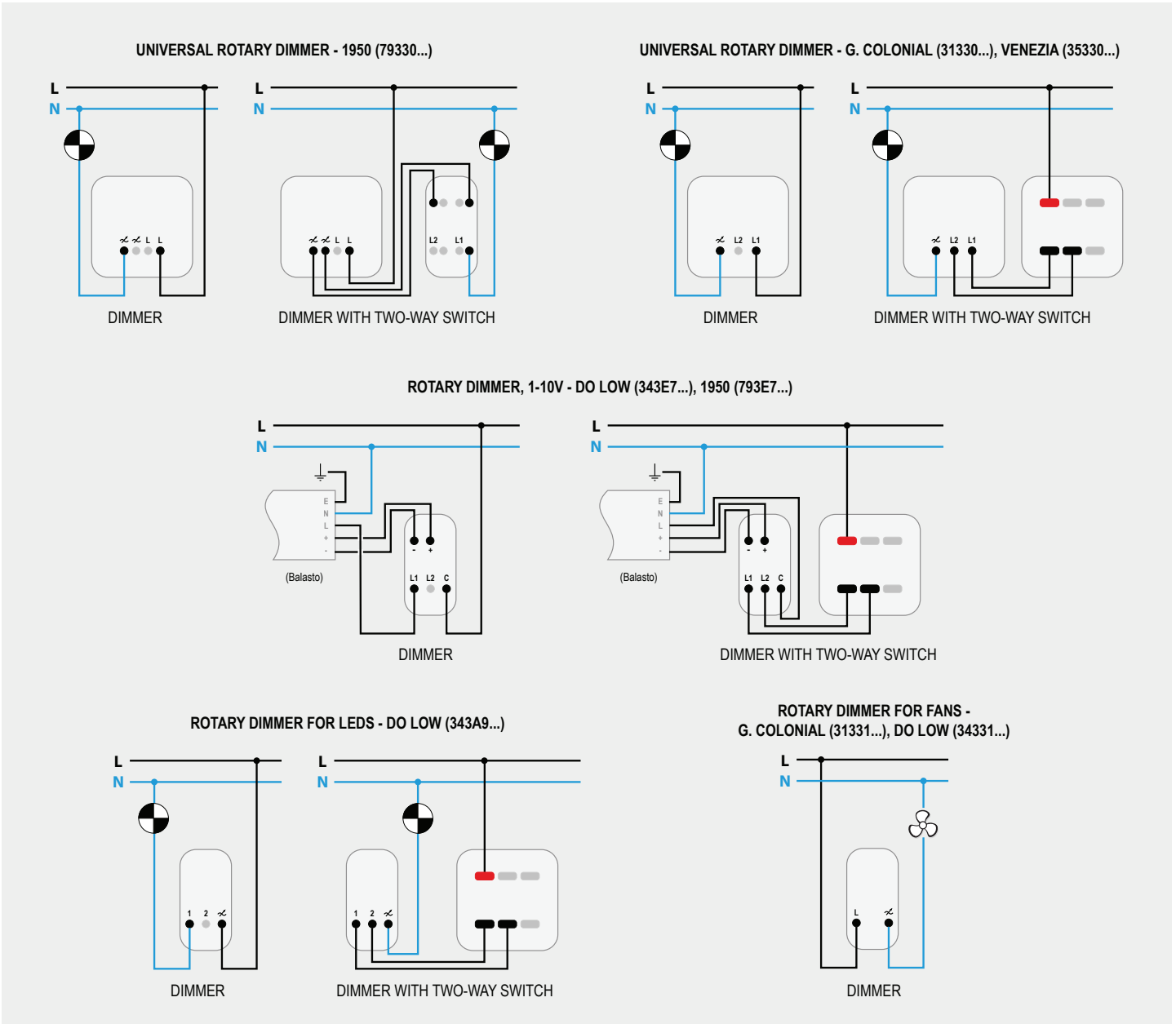

Wiring diagrams | Other Applications

DO, DO LOW, GARBY, GARBY COLONIAL, VENEZIA & 1950 Collections

HOTEL CARD SWITCH, 1 MICROSWITCH - GARBY COLONIAL (37935...)

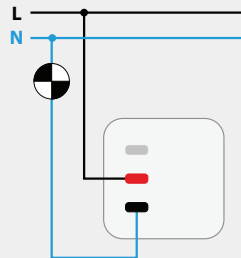

HOTEL CARD SWITCH, 2 MICROSWITCHES - GARBY COLONIAL (37936...)

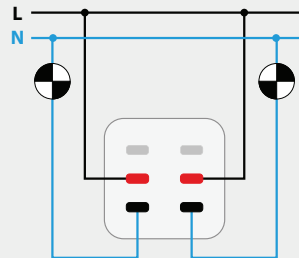

IR DETECTOR WITH PUSH BUTTON - GARBY COLONIAL (37750...), 1950 (79750...)

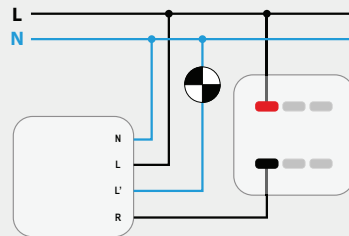

THERMOSTAT - 1950 (797300...)

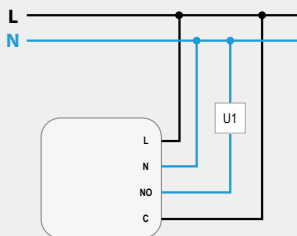

CONNECTED THERMOSTAT - 1950 (79731...) + SENSOR (7973200)

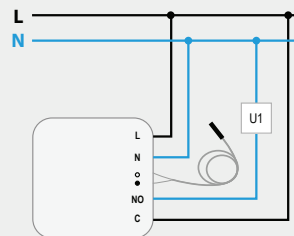

R/TV-SAT SOCKET

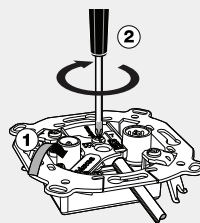
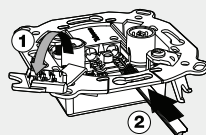
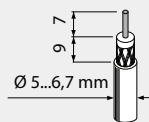

Cable removal:

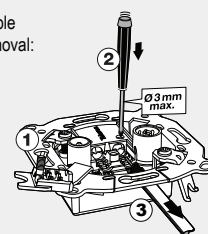

RJ45 SOCKET

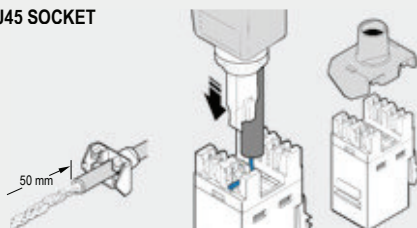

T568B



T568A



For connection as a telephone socket (RJ11 or RJ12), only connect the terminals marked blue and blue/white.